

- Notes
1. DO NOT SCALE - Use figured dimensions only
 2. All dimensions shown are in millimetres unless otherwise stated.
 3. All levels are in metres above ordnance datum unless otherwise stated.
 4. The Contractor is to verify all dimensions on site before commencing work or preparing shop drawings.
 5. This drawing is to be read in conjunction with all Engineers and Architects drawings.

- MASONRY
6. Blockwork to be minimum 3.6N/mm² compressive strength.
 7. Mortar above ground: Type (iii)/M4 to BS 5628-1 (2005) 1 : 5 to 6 (cement : sand) by volume.
 8. Mortar below ground: Type (ii)/M6 to BS 5628-1 (2005) 1 : 3 to 4 (cement : sand) by volume
 9. Blockwork below dpc to be 7N/mm² compressive strength.
 10. Vertical movement joints to be spaced at max 6m horz c/c in blockwork & 12m horz c/c in brickwork unless bed joint reinforcement has been specified.
 11. All cavity walls to be constructed with Type 2 cavity wall ties (Ancor RT2 or similar). Installed at 750 horz c/c & 450 vert c/c (or to provide not less than 2.5 ties/m²). Additional ties spaced at 225 vert c/c within a distance of 225mm of all openings, movement joints & roof verges.

- FOUNDATIONS
12. Abbreviations:
 FFL = Finished Floor Level
 SSL = Structural Slab Level
 GL = Ground Level
 TOC = Top of Concrete
 FL = Formation Level
 13. Concrete grades for foundations (to BS 5328):
 Unreinforced foundations = GEN3 designated mix
 Reinforced foundations = RC40 designated mix
 14. All foundations to be built centrally under substructure wall construction unless noted otherwise.
 15. For exact setting out dimensions refer to Architect's drawings.
 16. Any soft spots in formation to be excavated and infilled with lean mix concrete.
 17. Cast foundation immediately after formation level is reached. If excavation is to be left open then cast a 50mm blinding layer immediately.
 18. Formation to be approved by local building control or approved inspector; assumed safe bearing capacity 200kN/m² (from AVZ GeoEng site investigation report ref: SKZ_1887/22).

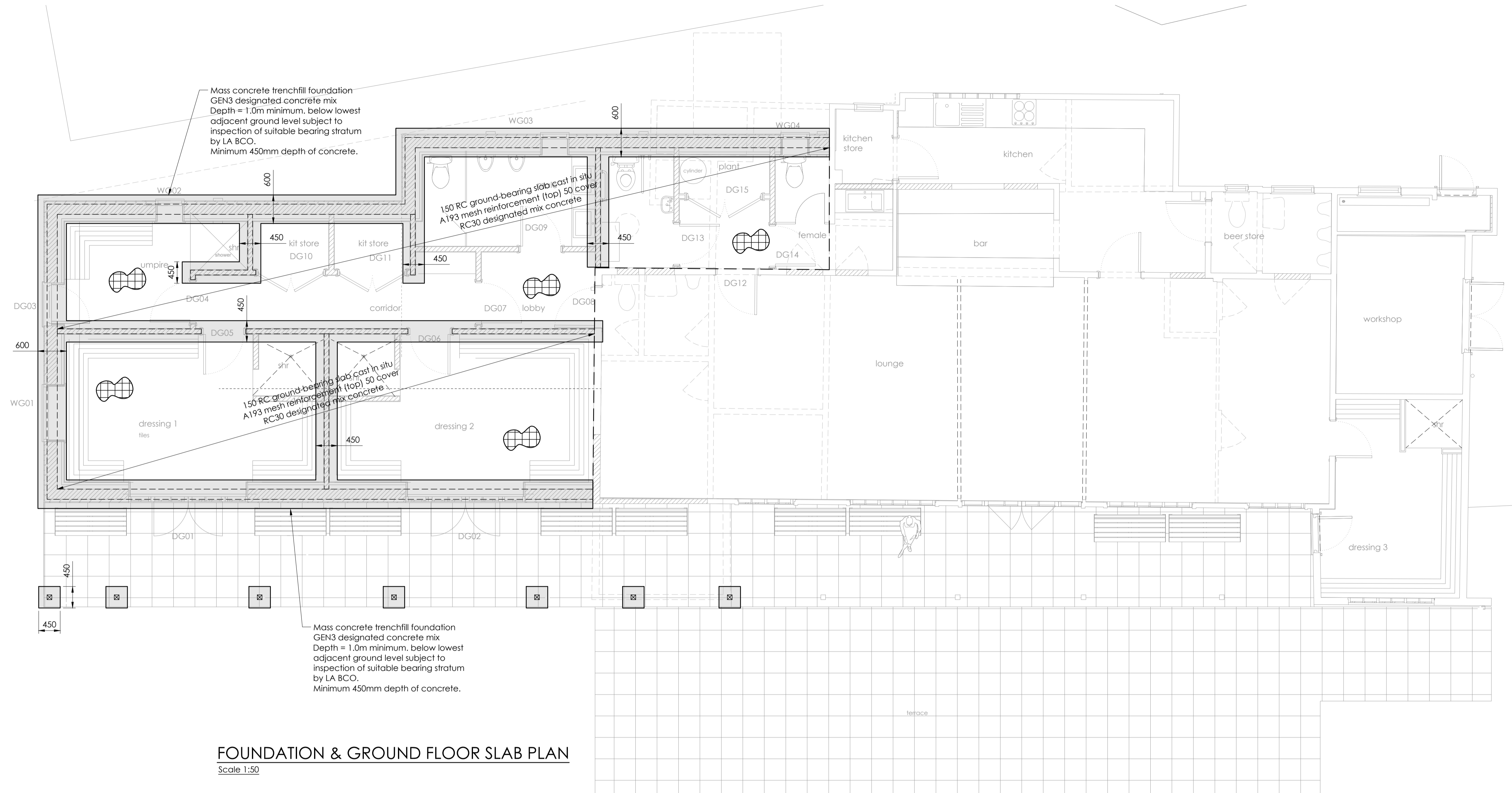

FOUNDATION & GROUND FLOOR SLAB PLAN
 Scale 1:50

A 15.09.22 PRELIMINARY ISSUE		PMC MM	
Rev	Date	Description	Drawn/Chkd
Client name			
Project title SONNING CRICKET CLUB PAVILION			
Drawing title FOUNDATIONS & GROUND FLOOR SLAB LAYOUT			
Issued	Drawn	Checked	Sheet size
SEP 22	PMC	MM	A1
Drawing number 22-079/100			Scale As shown
			Revision A

PRELIMINARY

© This drawing is copyright OMK Design Consultancy Ltd and shall not be reproduced without our prior permission